

SURFACE-MOUNT DOOR LOOPS

stainless steel loops

- End caps in Zamak nickel finishing
- Integrated door loop holding piece
- Different lengths available
- Fixing screws provided



DLI7

CHARACTERISTICS

Product number	Dimensions H x W x D	
DLI7/30	300 x 7 mm	-10 +60 °C
DLI7	500 x 7 mm	
ECRLI7	42,5 x 28 x 14 mm	
DLI10	500 x 10 mm	
ECRLI10	48 x 32 x 16 mm	

DLI7/30	Stainless steel door loop 30 cm diameter 9/7 mm	0,1 kg
DLI7	Stainless steel door loop 50 cm diameter 9/7 mm	0,1 kg
RLI7	Stainless steel door loop 10 m roll diameter 9/7 mm	0,6 kg
ECRLI7	Nickel-plated end caps for RLI7 Pack of 20	0,6 kg
DLI10	Stainless steel door loop 50 cm diameter 13/10 mm	0,1 kg
RLI10	Stainless steel door loop 10 m roll diameter 13/10 mm	0,8 kg
ECRLI10	Nickel-plated end caps for RLI10 Pack of 20	0,7 kg

Customs code
83071000

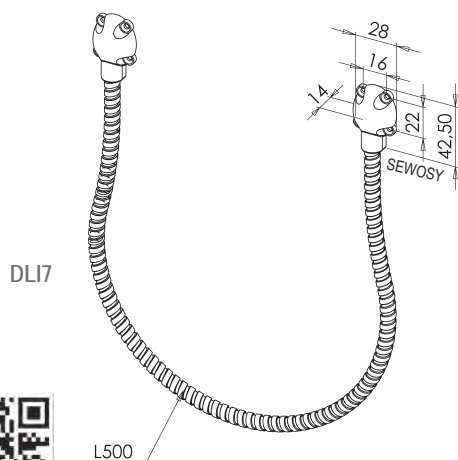

DLI7

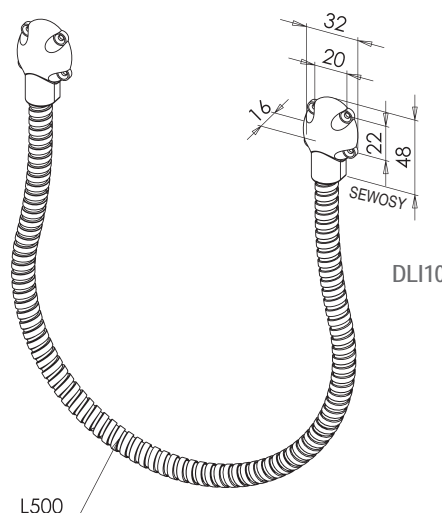

DLI10

